

DEPARTMENT: Planning

BY: Kris Schenk, Director
PHONE: 966-5151

RECOMMENDED ACTION AND JUSTIFICATION:

Adopt a resolution approving the road name "Shooting Star Road" for the subject easement. The road name is consistent with the road naming requirements of County Resolution No. 92-541. Shooting Star is a native flower at the proposed site. All property owners served by the road approve of the proposed road name request.

BACKGROUND AND HISTORY OF BOARD ACTIONS:

The Board adopted Resolution No. 92-541 in 1992 establishing criteria for naming non-County roads. In accordance with this resolution, road names are to be developed around some historical, botanical, zoological or geological significance as they directly relate to Mariposa County. All property owners served by the road must be notified. If it is shown that a majority of the property owners served by a road cannot reach an agreement on a proposed name, then a property owner served by the road may request that the Board of Supervisors name the road.

ALTERNATIVES AND CONSEQUENCES OF NEGATIVE ACTION:

A road name is a condition of approval for Land Division 2007-189. If the road remains unnamed then the recording of the parcel/final map would be delayed until the road name is resolved.

Financial Impact? () Yes (X) No	Current FY Cost: \$	Annual Recurring Cost: \$
Budgeted In Current FY? () Yes () No () Partially Funded		
Amount in Budget: \$		List Attachments, number pages consecutively
Additional Funding Needed: \$		Project Road Name Map
Source:		Tentative Map
Internal Transfer		Application
Unanticipated Revenue	_____ 4/5's vote	
Transfer Between Funds	_____ 4/5's vote	
Contingency	_____ 4/5's vote	
() General () Other		

CLERK'S USE ONLY:

Res. No.: 11-88 Ord. No. _____
 Vote - Ayes: 5 Noes: _____
 Absent: _____
 Approved
 () Minute Order Attached () No Action Necessary

COUNTY ADMINISTRATIVE OFFICER:

Requested Action Recommended
 No Opinion
 Comments:

The foregoing instrument is a correct copy of the original on file in this office.

Date: _____
 Attest: MARGIE WILLIAMS, Clerk of the Board
 County of Mariposa, State of California

By: _____
 Deputy

CAO: [Signature]

Mariposa County Board of Supervisors

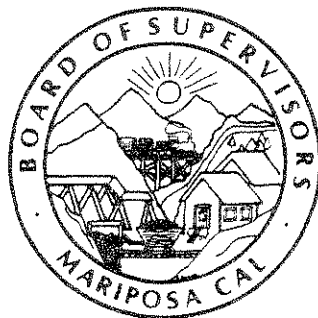

District 1 LEE STETSON
 District 2 LYLE TURPIN
 District 3 JANET BIBBY
 District 4 KEVIN CANN
 District 5 JIM ALLEN

March 15, 2011

RICHARD J. BENSON
 County Administration Officer

MARGIE WILLIAMS
 Clerk of the Board

P. O. Box 784
 Mariposa, CA 95339
 (209) 966-3222
 (800) 736-1252

Fax (209) 966-5147

www.mariposacounty.org/board

State of California Department of Forestry 5366 Highway 49 North Mariposa, CA 95338	Terry Hicks, Postmaster United States Post Office 5008 Main Street Coulterville, CA 95311	David Martin, District Ranger U.S. Forest Service Bass Lake Ranger District 57003 Road 225 North Fork, CA 93643-9734	United Parcel Service Attn: Clint Robison 334 South Highway 59 Merced, CA 95341
Sierra Telephone Linda Burton Post Office Box 219 Oakhurst, CA 93644	Pacific Gas and Electric Attn: Mr. Butch Johnson Post Office Box 158 Mariposa, CA 95338	Mercy Ambulance Attn: Gene Poole Post Office Box 5004 Mariposa, CA 95338	John C. Fremont Healthcare Post Office Box 216 Mariposa, CA 95338
Sierra Telephone Attn: Marc McNally Post Office Box 219 Oakhurst, CA 93644	AT&T Data Base Center/SLOC 177 E. Colorado Blvd., #1055 Pasadena, CA 91105-1936	Lori Wagner Public Works Coordinator 2300 E. Eight Mile Road, Room 101 Stockton, CA 95210	Postmaster United States Postal Service Mariposa, CA 95338
Mrs. Carolyn Jones (911 Services) Mariposa Sheriff's Dept. Post INTEROFFICE	Becky Crafts Assessor Recorder Mariposa County INTEROFFICE	Allen Toschi Public Works Director INTEROFFICE	Jim Pierce CAL FIRE Madera-Mariposa-Merced Unit 5366 Hwy 49 North Mariposa, CA 95338
Dept. of Human Services Social Services Division Attn: Susie Gordo INTEROFFICE	Keith Williams Mariposa County Clerk INTEROFFICE	Mariposa County Unified School District INTEROFFICE	Mariposa/Yosemite Chamber of Commerce INTEROFFICE
Emily Meriam GIS Specialist Planning Department INTEROFFICE	Jim Wilson, Fire Chief Emergency Services Officer INTEROFFICE	Kris Schenk, Director Mariposa County Planning INTEROFFICE	Doug Binnewies, Sheriff Mariposa Sheriff's Dept. INTEROFFICE

TO: THOSE LISTED

Please be advised that at the Board meeting of March 15, 2011, the Mariposa County Board of Supervisors adopted Resolution Number 11-88 approving the road name "Shooting Star Road" as shown on the map attached.

Sincerely,

Tracy Gauthier
 Deputy Clerk of the Board

Attachment

Updated 6/24/10



MARIPOSA COUNTY PLANNING DEPARTMENT PROJECT ROAD NAME MAP

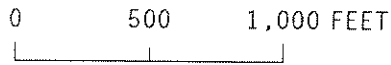
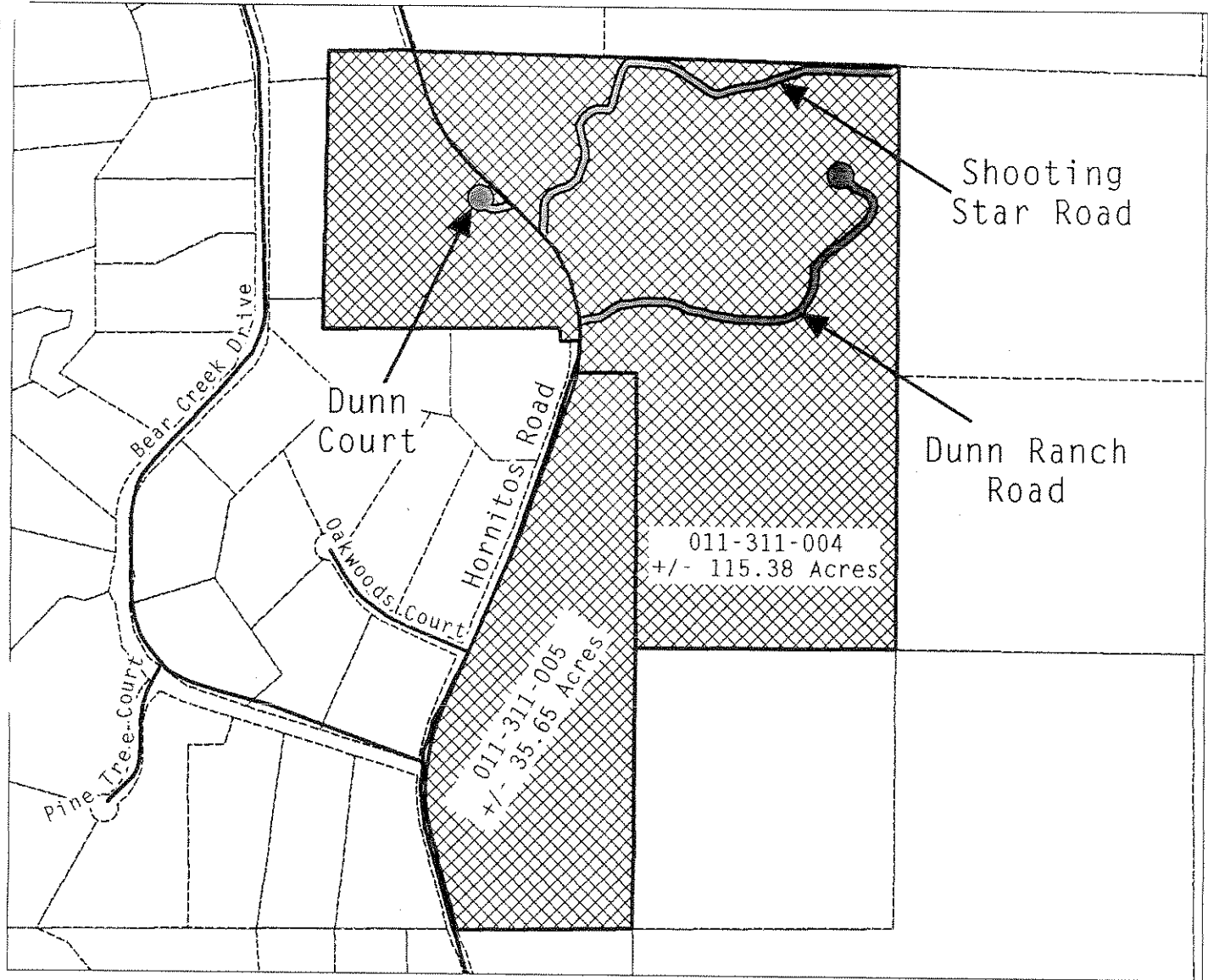





PROJECT TYPE: Major Subdivision 2007-189
Road Name Appl. 2010-097 Dunn Court
Road Name Appl. 2010-098 Dunn Ranch Road
Road Name Appl. 2010-099 Shooting Star Road

APPLICANT: Steve Allison, et al
APN'S: 011-311-004 & 011-311-005
SITE ADDRESS: 5556 Hornitos Road and UNASSIGNED
Catheys Valley, CA 95306

MAP CREATED ON: FEBRUARY 27, 2011
DATA SOURCE: PARCEL MAP FROM MARIPOSA COUNTY ASSESSOR DECEMBER 2010 UPDATE

MARIPOSA COUNTY PLANNING DEPARTMENT
PO BOX 2039 5100 BULLION STREET
MARIPOSA, CALIFORNIA 95338-2039
209.966.5151 FAX 209.742.5024
MARIPOSA@PLANNING@MARIPOSA.COUNTY.ORG
HTTP://WWW.MARIPOSA.COUNTY.ORG/PLANNING

MARIPOSA COUNTY MAKES NO WARRANTY REGARDING THE ACCURACY OF THE GIS OR THE ANALYSIS AND CONCLUSIONS RESULTING FROM USING OUR GIS DATA.

-  PROJECT LOCATION
-  ASSESSOR PARCEL MAP
-  NEW ROAD
-  ROADS

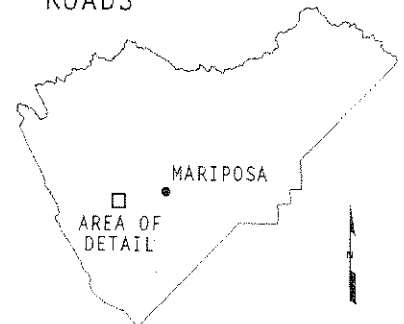

MAP CREATED BY: EE MERIAM, GIS TECHNICIAN

4TH REVISED
TENTATIVE SUBDIVISION MAP
OF
THE DANN RANCH

FOR
STEVE ALPHEI, ET AL
140 BOX 112
MADISON, MISSOURI
63703-0112

BEING A DIVISION OF A PORTION OF SECTIONS
27 & 28, T. 7 S., R. 17 E., M.D.B. # 11,
HARRISON COUNTY,
MISSOURI, 2008

TOTAL STARTING AREA: 151.03 +/- AC.
SCALE: 1" = 200'
COURTESY

PHASE I LOTS 1-3
PHASE II LOTS 4-18
PHASE III LOTS 19-28

- NOTES:
1. Contour interval is 5'.
 2. Distances determined by aerial survey.
 3. Contour elevations are provided in 100' intervals.
 4. The boundary between sections 27 and 28 is shown by a dashed line.
 5. The boundary between sections 27 and 28 is shown by a dashed line.
 6. The boundary between sections 27 and 28 is shown by a dashed line.
 7. The boundary between sections 27 and 28 is shown by a dashed line.
 8. The boundary between sections 27 and 28 is shown by a dashed line.
 9. The boundary between sections 27 and 28 is shown by a dashed line.
 10. The boundary between sections 27 and 28 is shown by a dashed line.
 11. The boundary between sections 27 and 28 is shown by a dashed line.

PREPARED BY
FREDERICK A. STEINBERG, L.S. & L.M.
PLANNING CORPORATION
1225 N. 17TH ST.
MADISON, MISSOURI 63703

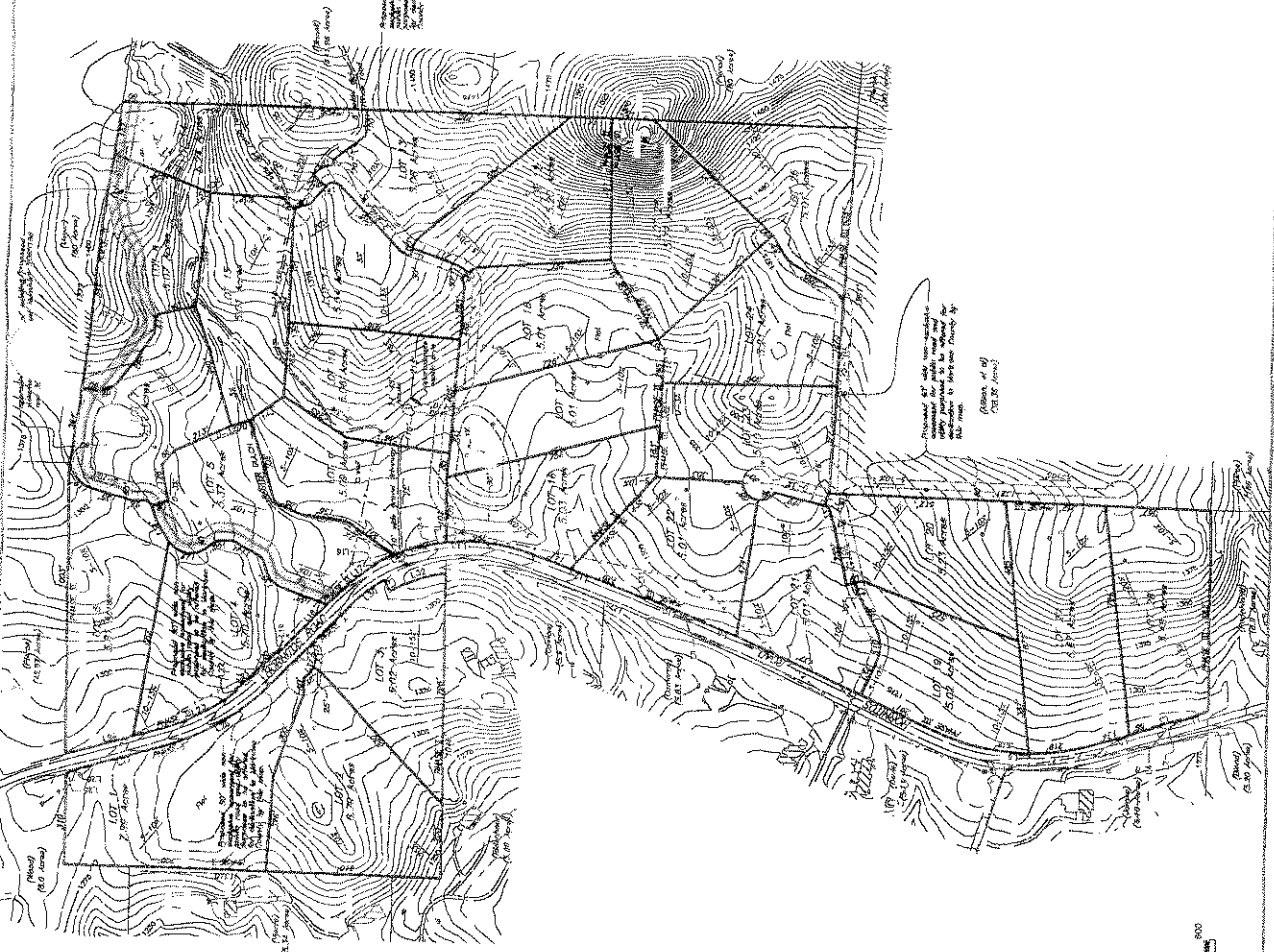

WEST SIDE OF EXISTING ROAD DATA

Corner	Bearing	Distance
118	S 72° 00' 00" W	143.50'
119	S 15° 00' 00" E	53.00'
120	S 75° 00' 00" W	143.50'
121	S 75° 00' 00" W	143.50'
122	S 75° 00' 00" W	143.50'
123	S 75° 00' 00" W	143.50'
124	S 75° 00' 00" W	143.50'
125	S 75° 00' 00" W	143.50'
126	S 75° 00' 00" W	143.50'
127	S 75° 00' 00" W	143.50'
128	S 75° 00' 00" W	143.50'
129	S 75° 00' 00" W	143.50'
130	S 75° 00' 00" W	143.50'
131	S 75° 00' 00" W	143.50'
132	S 75° 00' 00" W	143.50'
133	S 75° 00' 00" W	143.50'
134	S 75° 00' 00" W	143.50'
135	S 75° 00' 00" W	143.50'
136	S 75° 00' 00" W	143.50'
137	S 75° 00' 00" W	143.50'
138	S 75° 00' 00" W	143.50'
139	S 75° 00' 00" W	143.50'
140	S 75° 00' 00" W	143.50'

EAST SIDE OF EXISTING ROAD DATA

Corner	Bearing	Distance
141	N 72° 00' 00" E	143.50'
142	N 15° 00' 00" E	53.00'
143	N 75° 00' 00" E	143.50'
144	N 75° 00' 00" E	143.50'
145	N 75° 00' 00" E	143.50'
146	N 75° 00' 00" E	143.50'
147	N 75° 00' 00" E	143.50'
148	N 75° 00' 00" E	143.50'
149	N 75° 00' 00" E	143.50'
150	N 75° 00' 00" E	143.50'
151	N 75° 00' 00" E	143.50'
152	N 75° 00' 00" E	143.50'
153	N 75° 00' 00" E	143.50'
154	N 75° 00' 00" E	143.50'
155	N 75° 00' 00" E	143.50'
156	N 75° 00' 00" E	143.50'
157	N 75° 00' 00" E	143.50'
158	N 75° 00' 00" E	143.50'
159	N 75° 00' 00" E	143.50'
160	N 75° 00' 00" E	143.50'
161	N 75° 00' 00" E	143.50'
162	N 75° 00' 00" E	143.50'
163	N 75° 00' 00" E	143.50'
164	N 75° 00' 00" E	143.50'
165	N 75° 00' 00" E	143.50'
166	N 75° 00' 00" E	143.50'
167	N 75° 00' 00" E	143.50'
168	N 75° 00' 00" E	143.50'
169	N 75° 00' 00" E	143.50'
170	N 75° 00' 00" E	143.50'
171	N 75° 00' 00" E	143.50'
172	N 75° 00' 00" E	143.50'
173	N 75° 00' 00" E	143.50'
174	N 75° 00' 00" E	143.50'
175	N 75° 00' 00" E	143.50'
176	N 75° 00' 00" E	143.50'
177	N 75° 00' 00" E	143.50'
178	N 75° 00' 00" E	143.50'
179	N 75° 00' 00" E	143.50'
180	N 75° 00' 00" E	143.50'
181	N 75° 00' 00" E	143.50'
182	N 75° 00' 00" E	143.50'
183	N 75° 00' 00" E	143.50'
184	N 75° 00' 00" E	143.50'
185	N 75° 00' 00" E	143.50'
186	N 75° 00' 00" E	143.50'
187	N 75° 00' 00" E	143.50'
188	N 75° 00' 00" E	143.50'
189	N 75° 00' 00" E	143.50'
190	N 75° 00' 00" E	143.50'
191	N 75° 00' 00" E	143.50'
192	N 75° 00' 00" E	143.50'
193	N 75° 00' 00" E	143.50'
194	N 75° 00' 00" E	143.50'
195	N 75° 00' 00" E	143.50'
196	N 75° 00' 00" E	143.50'
197	N 75° 00' 00" E	143.50'
198	N 75° 00' 00" E	143.50'
199	N 75° 00' 00" E	143.50'
200	N 75° 00' 00" E	143.50'

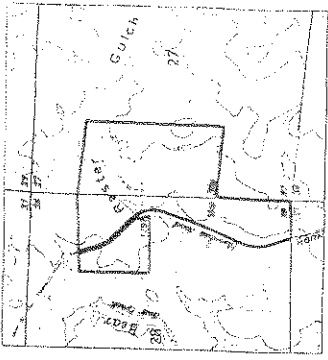

MONEY LAKE
T.S. & L.M. # 11

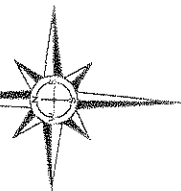

Scale 1" = 200'
0 100 200 300
FOOT
VERTICAL SCALE = 1/2"

2

FREEMAN & SEAMAN LAND SURVEYORS
10000 W. 110th Street, Suite 100
Overland Park, MO 66213
Tel: 913.241.1100
www.freemanandseaman.com



MARIPOSA COUNTY
ROAD NAME APPLICATION AND
GENERAL INFORMATION

Mariposa County Planning Department
 5100 Bullion Street, P.O. Box 2039
 Mariposa, CA 95338
 Telephone (209) 966-5151 FAX (209) 742-5024
www.mariposacounty.org

COPY

RECEIVED

FEB 23 2011

Mariposa Planning Dept.

	For Office Use Only
Date Submitted _____	Received By _____
Date Complete _____	Board Action _____

Applicant Steven P. Allison
 Address PO Box 1157 Mariposa, Ca 95338
 Telephone (209) 966-4082 E-Mail Address _____

PROPOSED ROAD NAME 1) Shooting Star Road; 2) Meadowlark Lane; 3) Starling Lane

Is this application being submitted to comply with a condition for a Land Division Application? YES NO
 If yes, please indicate the Land Division Application Number 2007-189

EXPLAIN THE MEANING AND REASON FOR CHOOSING THE PROPOSED ROAD NAME
 (as it relates to the Mariposa County Road Naming Policy):

1) Native flower.

2) Native bird.

3) Native bird.

Number of properties served by the road in question 2

In accordance with the adopted policy on street/road names, property owners who own a majority of the parcels having access to the road must approve the road name under consideration. The spaces below are provided for the signature of property owners who either approve or disapprove of the name. Owners of undeveloped parcels must be included. Separate letters may also provide signatures. Please be advised that naming an existing unnamed road will change your physical street address and mailing address if your mail is delivered to your street address.

	Approve	Disapprove	Printed Name	Signed Name	Assessor's Parcel Number
<input type="checkbox"/>	<input type="checkbox"/>	<input type="checkbox"/>	<u>Steven P. Allison</u>	<u>SP Allison</u>	<u>011-311-004</u>
<input type="checkbox"/>	<input type="checkbox"/>	<input type="checkbox"/>	<u>Linda & Ron Dinnel</u>	<u>Ron + Linda Dinnel</u>	<u>011-311-007</u>
<input type="checkbox"/>	<input type="checkbox"/>	<input type="checkbox"/>	_____	_____	_____
<input type="checkbox"/>	<input type="checkbox"/>	<input type="checkbox"/>	_____	_____	_____
<input type="checkbox"/>	<input type="checkbox"/>	<input type="checkbox"/>	_____	_____	_____
<input type="checkbox"/>	<input type="checkbox"/>	<input type="checkbox"/>	_____	_____	_____
<input type="checkbox"/>	<input type="checkbox"/>	<input type="checkbox"/>	_____	_____	_____
<input type="checkbox"/>	<input type="checkbox"/>	<input type="checkbox"/>	_____	_____	_____
<input type="checkbox"/>	<input type="checkbox"/>	<input type="checkbox"/>	_____	_____	_____

END