

Property C Property B

Property A

TOWN OF COULTERVILLE UTILITY AREA

- NOTES:**
1. THIS MAP WAS DRAWN USING ASSESSOR'S MAP BOOKS (A.M.B.)
 2. THIS MAP IS FOR PICTORIAL PURPOSES ONLY
 3. IN CALCULATING THE BOUNDARY OF THE UTILITY AREA PER RESOLUTION NO. 70-4, IT WAS FOUND THAT THE BOUNDARY DOES NOT CLOSE BY NORTH 48.67' AND EAST 4.87'. THE ERROR OF CLOSURE IS 1' : 30'



LEGEND

- UTILITY SERVICE AREA BOUNDARY (Per Resolution No. 70-4 M.C.R.)
- - - TOWNSITE AREA BOUNDARY (Per Volume 5, Deeds, Page 9, M.C.R.)
- TOWN PLANNING AREA BOUNDARY (Per Planning Department)
- M.C.R. Mariposa County Records

SCALE: 1"=500'

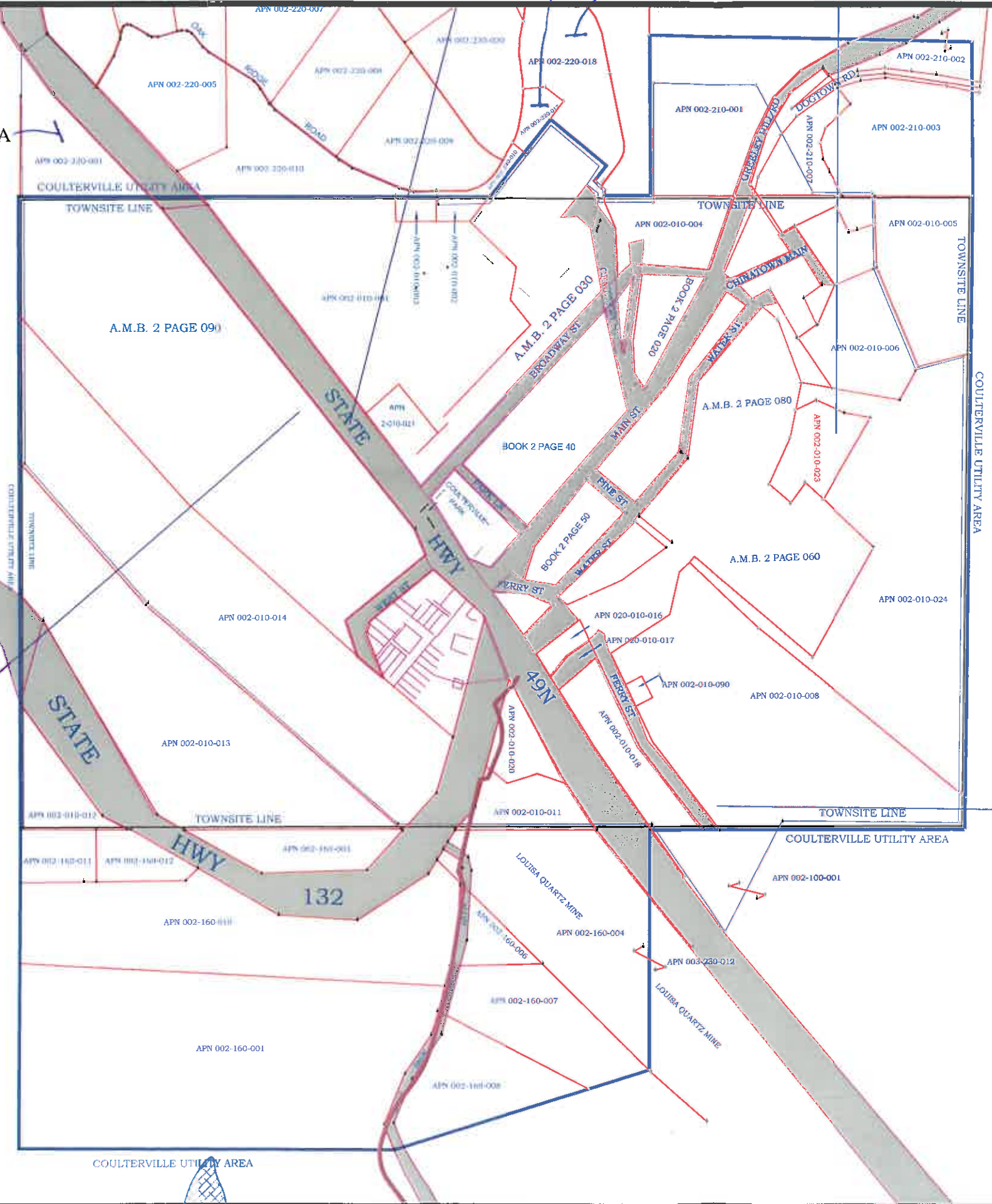

DATE: 6/29/2007

DRAWN BY:

COUNTY OF MARIPOSA DEPARTMENT OF PUBLIC WORKS

PROJECT NO.
PW-00-00
SHEET 1 OF 1

Exhibit E